

B1
SM1
TO MATCH EXISTING CONSTRUCTION
AND CARPARKS

NEW CONSTRUCTION

KERB AND CHANNEL SECTIONS

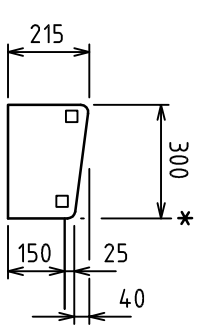
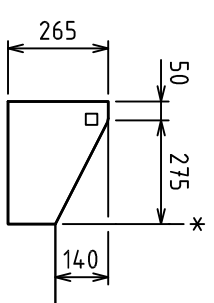
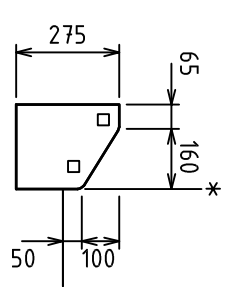
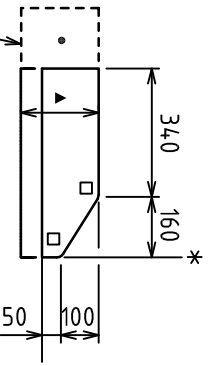
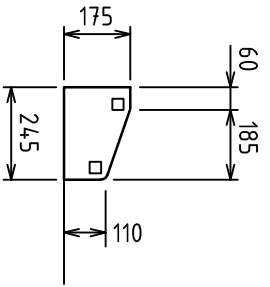
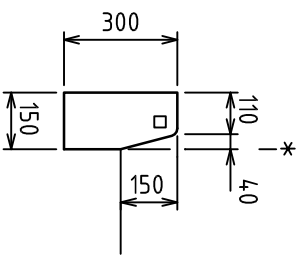

B2
B5
SM5
SM3
M4
M6
TO BE USED ONLY WHERE APPROVED

160 concrete widening (with Y12 centrally located) to provide a 500 wide maintenance strip at landscaped medians. Refer to B.S.C. Std. Dwg. 504.12 for further details.

KERB SECTIONS

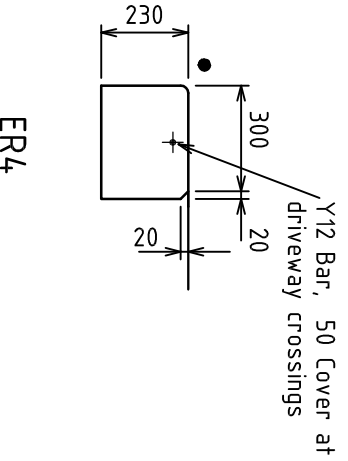
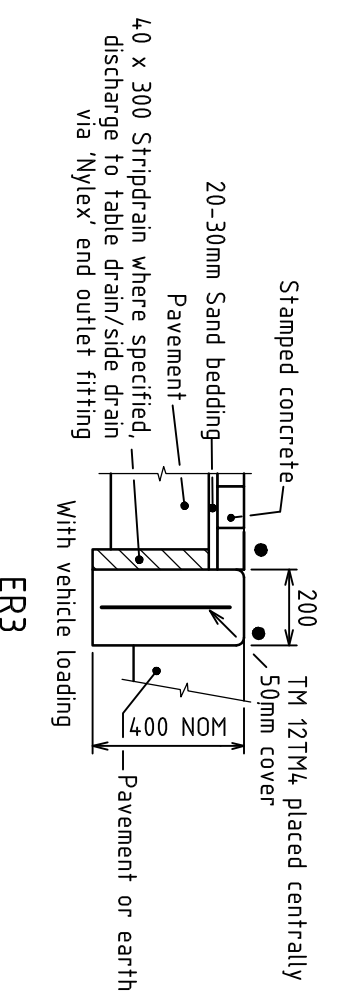
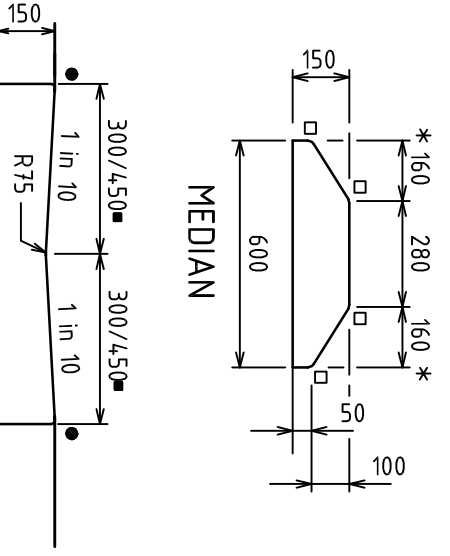

EDGE RESTRAINT / FLUSH KERB

- NOTES:**
1. All materials and construction shall comply with AS 2876 except for dimensions on this drawing.
 2. All concrete N25 MIN (refer project documentation) in accordance with AS1379 and AS 3600.
 3. Reinforcement bars to AS 1302, trench fabric to AS 1304.
 4. All dimensions in millimetres.
- LEGEND**
- * Nominal kerb line for setting out.
 - Channel, invert width – refer project drawings.
 - 10mm Radius.
 - R20 Radius.
 - 175 Where specified for commercial and industrial applications. Refer project specifications.
 - ▲ 250 in new road construction

E								
D								
C								
B	ER4 REVISED	02/05	APPROVED : ORIGINAL APPROVED ISSUE SIGNED	APPROVED : DIRECTOR DESIGN AND DEVELOPMENT	APPROVED ISSUE DATE			
A	ORIGINAL ISSUE	10/99	APPROVED : ORIGINAL APPROVED ISSUE SIGNED	APPROVED : DIRECTOR DESIGN AND DEVELOPMENT	APPROVED ISSUE DATE			
REVISIONS		APPROVED	DATE					

STANDARD DRAWING

KERB AND CHANNEL PROFILES

BASED ON AND SUPERSEDES
 I.M.E.A.O. STD. DWG. R-0080 &
 B.S.C. STD. DWG. A3-005745
 COUNCIL DRAWING NO.
504.10



DO NOT SCALE
 TAKE FIGURED DIMENSIONS ONLY

RECOMMENDED : G.I. SMART B.E. (Civil), R.P.E.Q. 4791

ORIGINAL APPROVED ISSUE SIGNED

APPROVED : DIRECTOR DESIGN AND DEVELOPMENT

ORIGINAL APPROVED ISSUE SIGNED

APPROVED DATE